

69893E.01.093

Stop valve. External part - finish Matt Black



FEATURES

Material	Brass/Marble
Installation	Wall concealed part
Control type	Single lever
Outlets	1 Way Out
Required for installation	<u>27891.00.000</u>
Required for installation	<u>27893.00.000</u>
Required for installation	<u>27892.00.000</u>
Required for installation	<u>27895.00.000</u>

TECHNICAL DRAWING

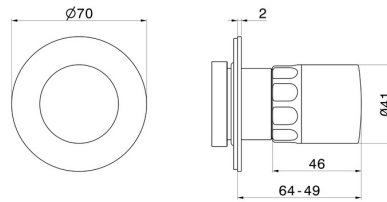



69893E.01.093

Stop valve. External part - finish Matt Black

AVAILABLE FINISHES



01.093

Matt Black



01.014

finish Matt White



21.018

finish Chrome



59.064

finish PVD Brushed Gun Metal



59.066

finish PVD Brushed steel



59.067

finish PVD Brushed Copper Bronze



59.098

finish PVD Brushed Pale Gold



61.020

finish PVD Glossy Gold